



Calgary Airport Authority Airport Planning Update

To

Balzac Community Advisory

Panel (BALCAP)

March 10, 2009



Calgary Airport Authority

Who we are:

Not for Profit company incorporated in 1990 under the Regional Airports Authorities Act of Alberta

Operate both the Calgary International (1992) and Springbank Airports (1997) under a long term lease with Transport Canada

Approximately 160 employees and company recently recognized as one of top 40 Alberta employers in 2008



Calgary Airport Authority

What we do:

Manage and operate the airports for which we are responsible in a safe, secure and efficient manner.

Advance economic and community development by means that include promoting and encouraging improved airline and transportation service and an expanded aviation industry

For the general benefit of the public in our region



Fast Facts

- 5142 acre site
- 780 acres of leased land
- 3rd busiest airport in Canada
- 12.5m pax in 2008
- 250,000 aircraft movements



Fast Facts

- 134,000 tonnes of cargo
- Approx 1.5 million sq feet of terminal space
- 3 runways
 - 16/34 3863 m
 - 10/28 2438 m
 - 07/25 1890 m



Economic Impact

- New air carriers – KLM, Lufthansa, Mexicana, British Airways
- \$6B value added GDP
- 15000 employees on site
- 40000 airport generated jobs



2004 Master Plan

- Parallel Runway 16L-34R
- International Terminal expansion
- High speed runway exits
- Golf course
- Trade parks
- Ground transportation



Land Use Plan

Trade parks:

- Deerfoot North
- Deerfoot South(1 & 2)
- McKnight
- McCall South
- McCall Central
- McCall North
- Barlow North

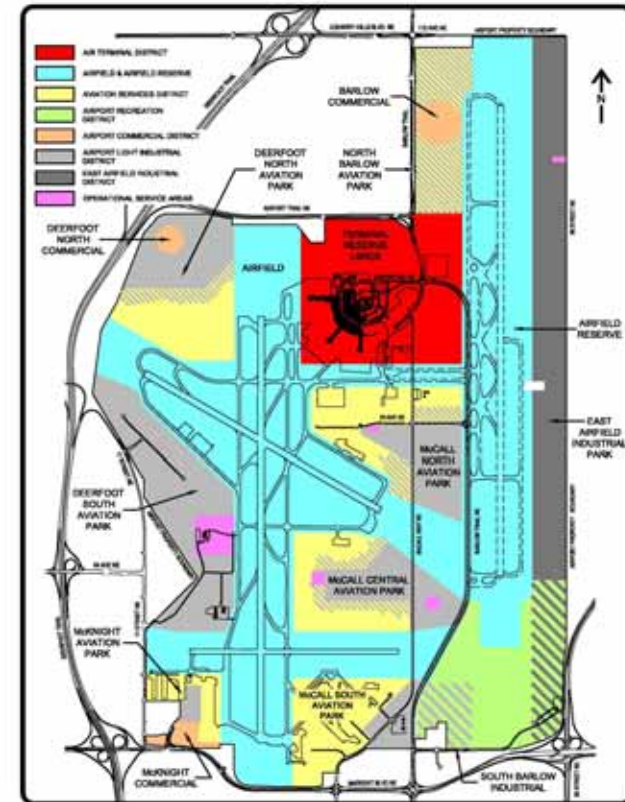

Recent Changes

- 2002 Concourse D – 11 gates
- 2000 -Concourse D widening
- Taxi Hotel
- Apron 7
- Cell phone lot
- Discount parking
- Parkade expansion

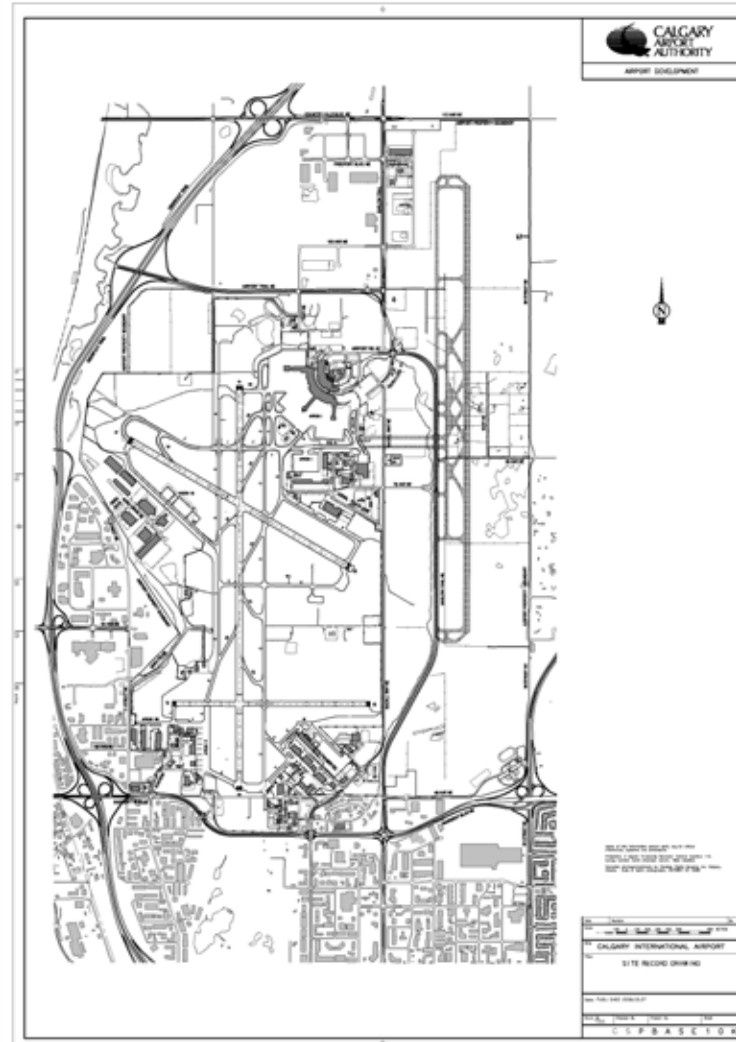

Terminal Area Plan

- **Parkade expansion**
- **International Facilities Terminal**
- **Expanded taxiway and apron**
- **Centralized Deicing**

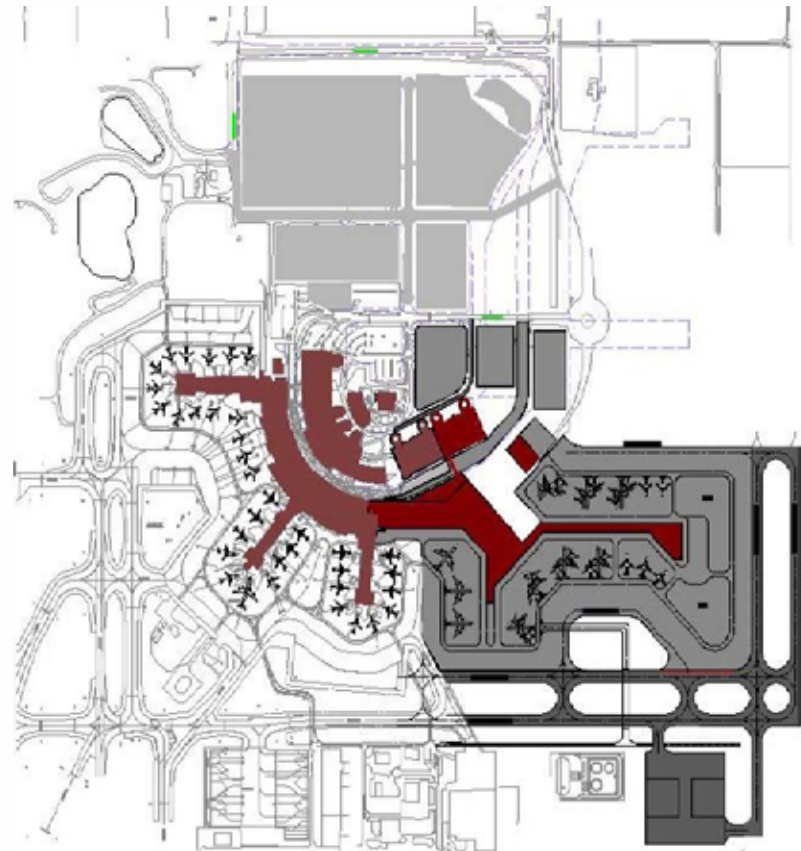

Ground Transportation

CITY/AIRPORT LONG TERM ROAD DEVELOPMENT NETWORK
DRAFT AS OF OCTOBER 23, 2003

NOTES:

- ROAD NETWORK BASED ON 1.5 MILLION POPULATION.
- NETWORK HAS BEEN MODELED BY CITY TRANSPORTATION GROUP.
- HIGHER LEVEL OF SERVICE THAN EXISTING NETWORK.

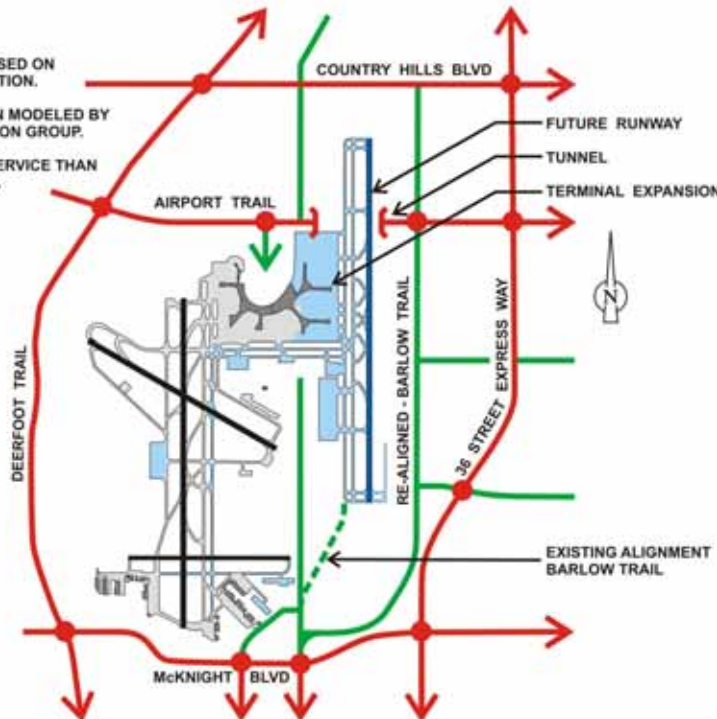

- Barlow closure
- McCall way termination at 78th
- 36th Street
- Metis Trail
- Ring Road
- Country Hills Widening

Parallel Runway 16L – 34R

- **4th Runway**
 - **Most important 14000 feet in Alberta**
 - **Registered Zoning and noise protection in place since 1979**
 - **Target date - 2014**
 - **Code F aircraft capable**
 - **500 M dollars**
-

Parallel Runway

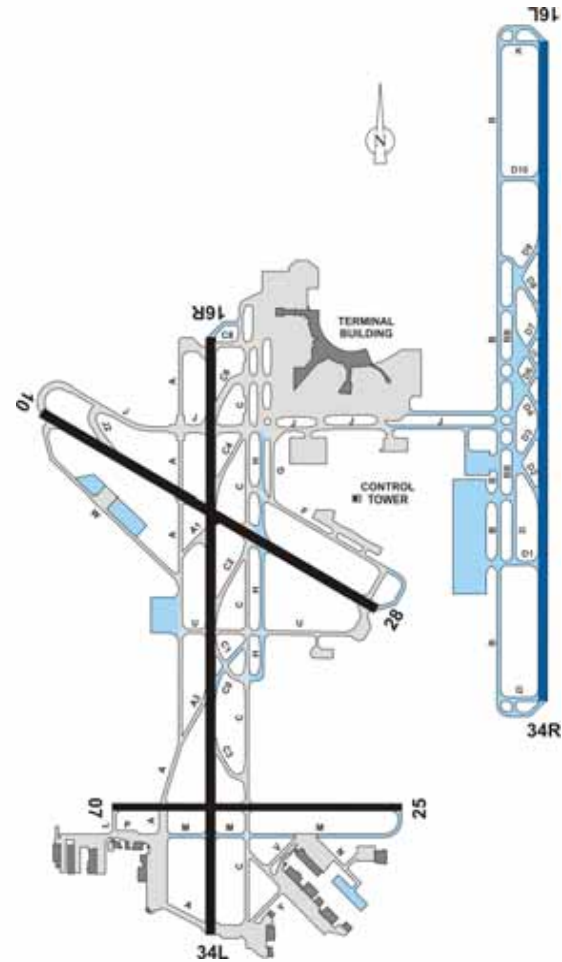
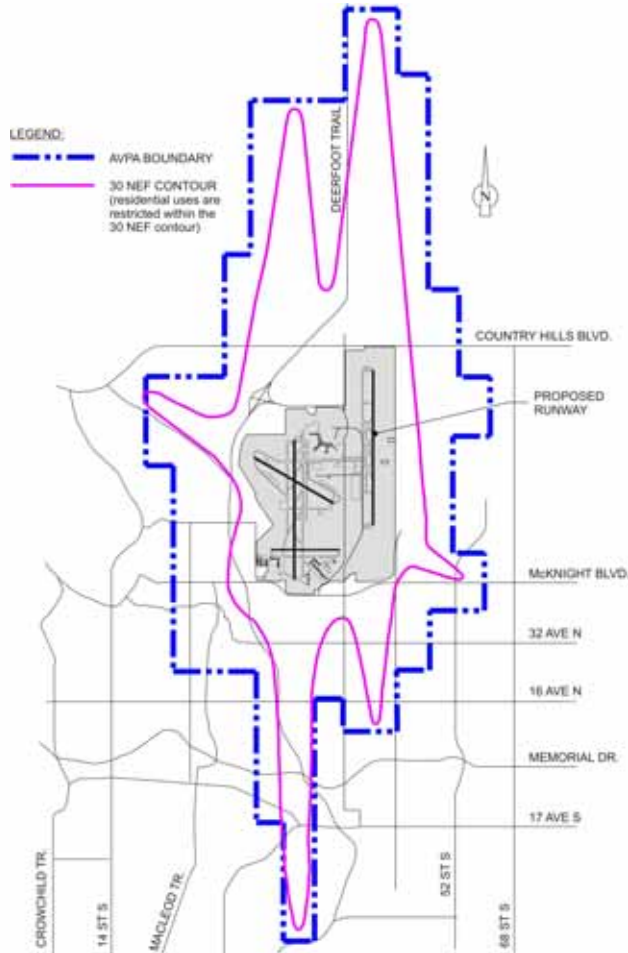

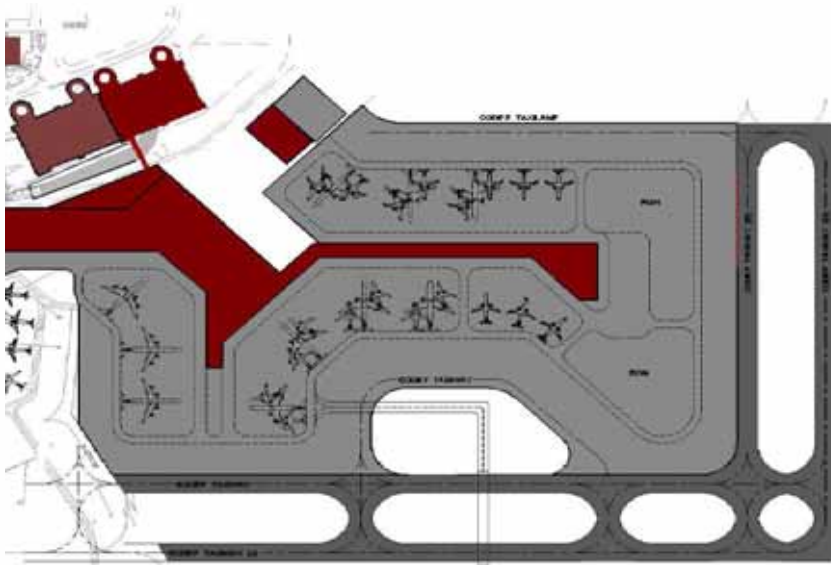

- **Expanding Alberta's premier gateway**
- **Dedicated International/ Transborder Concourse**
- **120,000 sq meters**
- **20 aircraft gates**
- **In service 2015**
- **1.3B dollars**

Other initiatives

- AVPA Regulation review
 - Concourse A pre board screening expansion
 - Additional gates on Concourse A
-

Future??



Questions or Comments?

